



70th Anniversary
BEVERAGE-AIR
 MADE IN AMERICA SINCE 1944



Worktops/Undercounters (WT/UC Series)

Certified to Ambient Class of 100°F

*Only 48"
 Dual-
 Temperature
 Unit in the
 Industry!*



Stainless steel top

Anti-sagging cartridge style hinges

Snap-in door gaskets

2 shelves per door

*Field-reversible doors with
 120° stay open feature*

*6" casters standard,
 3" ADA models available*

Dare to Compare!

Models available: Refrigerator or freezer, dual-temperature, shallow depth, glass door, door and drawer combination units. Offering the smallest worktops and undercounters in the industry!



Scan Here
 for Additional
 Information
 on This
 Product



3 Year Parts/Labor
 Warranty & Additional
 2 Year Compressor
 Warranty

Available options: foot pedal door opener, LED lighting upgrade (glass door models), lane dividers, stacking collar, stainless steel interior



IN THIS SECTION:

WORKTOPS

Worktop Refrigerators & Freezers
- 29" Depth

Worktop Refrigerators & Freezers
- 32" Depth

Dual-Temp Worktops

UNDERCOUNTERS

Undercounter Refrigerators & Freezers
- 29" Depth

Undercounter Refrigerators & Freezers
- 32" Depth

Undercounter Refrigerators & Freezers
- Shallow Depth

Dual-Temp Undercounters

**DOOR & DRAWER
UNITS AVAILABLE**



WORKTOP REFRIGERATORS & FREEZERS

▶ Worktop Refrigerators & Freezers - 29" Base Only

TESTED & CERTIFIED TO AMBIENT CLASS OF 100°F

Worktop Refrigerators & Freezers 29" Base FEATURES:

Cabinet Finish

Stainless steel exterior front, top and sides. Aluminum interior.

Heavy Duty Construction

2" CFC and HCFC-free foamed-in-place polyurethane insulation.

Durable Worktop

2 1/2" Thick stainless steel worktop for added durability.

Removable Backsplash

4" High removable backsplash for flexibility and ease of cleaning.

120° Stay-Open Door Feature

2 Epoxy Coated Shelves Per Door Section Standard

(Models with doors) Includes 1 large shelf, 1 small shelf.

Field Reversible Doors

Door and Drawer Units Available

Drawer Pan Supports

Heavy duty pan supports provided hold pans in place. Drawers accommodate up to 6" deep pans. Food service pans are not included.

LED Lighting Standard

Snap-In Door and Drawer Gaskets

Easy to remove for cleaning or replacement without service agency.



Products that have earned the ENERGY STAR® are designed to protect the environment through superior energy efficiency. For a complete list of qualified models, visit www.energystar.gov/cfs. Click on Commercial Refrigerators & Freezers on the right-hand side of the page.



WTR27A,
WTF27AY



Cartridge Style Hinges Eliminates door sagging.

6" Heavy Duty Casters Standard (3" Casters or 6" Legs Optional) 3" caster (ADA Compliant) or 6" leg option available at no charge when specified on order (in lieu of 6" casters).

Interior Thermometer

Interior thermometer is standard to monitor cabinet temperature.

Refrigeration System

Operates at 36°–38°F for optimum food preservation.

Agency Certifications



WTR48A,
WTF48AY



WTRD48A-2

OPTIONAL SUFFIX

LEGEND

SUFFIX	OPTION
STD	Removeable backsplash
-FIP	Foamed In Place backsplash
-FLT	Flat Top, no backsplash

Specify model + optional suffix when placing order. See Accessories Section for pricing.

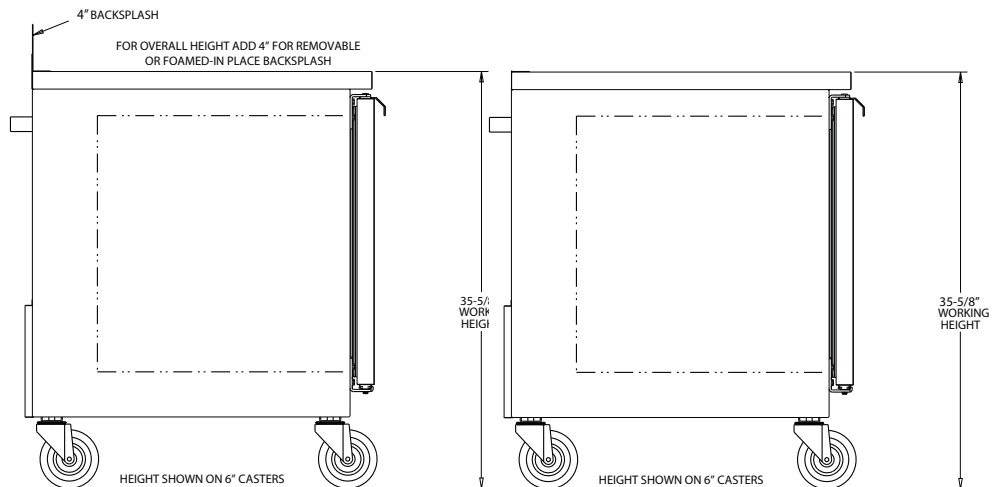

16" GAUGE TOP OPTION

27"	36"	48"	60"	72"
\$800	\$850	\$950	\$1,085	\$1,250

AVAILABLE ACCESSORIES:

- ▶ Cutting Board Top Options) ▶ Composite Cutting Boards
- ▶ Shelf Dividers ▶ Foot Pedal Door Opener
- ▶ Overshelf Kits



YOUR COMPLETE REFRIGERATION SOURCE

REMOVABLE BACKSPASH WORKTOP REFRIGERATORS 29" BASE - SPECIFICATIONS

	MODELS	LIST PRICE	CRATED WEIGHT	CUBIC FEET	EXT. DIMENSIONS - W x D x H	VOLTS / AMPS / HP	DOORS/ SHELVES
24"	WTR24A	\$3,806	160	7.0	24" x 29 1/4" x 39 1/2"	115/4.0/1/6	1 / 2
27"	WTR27A	\$3,806	161	7.3	27" x 29 1/4" x 39 1/2"	115 / 4.0 / 1/6	1 / 2
36"	WTR36A	\$5,320	210	8.5	36" x 29 1/4" x 39 1/2"	115 / 3.3 / 1/5	2 / 2
48"	WTR48A	\$5,800	235	13.9	48" x 29 1/4" x 39 1/2"	115 / 3.3 / 1/5	2 / 4
60"	WTR60A	\$6,450	265	17.1	60" x 29 1/4" x 39 1/2"	115 / 8.2 / 1/4	2 / 4
72"	WTR72AY	\$7,385	305	21.5	72" x 29 1/4" x 39 1/2"	115 / 8.2 / 1/5	3 / 6

For total depth add 2" for bumper and 1" for handle. Height includes 6" legs or casters and 4" backslash. ADA compliant models feature 3" casters and reduce height to 36 1/2".

FOAMED-IN PLACE BACKSPASH WORKTOP REFRIGERATORS 29" BASE - SPECIFICATIONS

	MODELS	LIST PRICE	CRATED WEIGHT	CUBIC FEET	EXT. DIMENSIONS - W x D x H	VOLTS / AMPS / HP	DOORS/ SHELVES
24"	WTR24A-FIP	\$3,806	160	7.0	24" x 29 1/4" x 39 1/2"	115/4.0/1/6	1 / 2
	WTR24A-FB	\$4,500	201	5.0	24" x 27" X 37 1/2"	115/5.0/1/4	1 / 2
27"	WTR27A-FIP	\$3,806	161	7.3	27" x 29 1/4" x 39 1/2"	115 / 4.0 / 1/6	1 / 2
36"	WTR36A-FIP	\$5,320	210	8.5	36" x 29 1/4" x 39 1/2"	115 / 3.3 / 1/5	2 / 2
48"	WTR48A-FIP	\$5,800	235	13.9	48" x 29 1/4" x 39 1/2"	115 / 3.3 / 1/5	2 / 4
60"	WTR60A-FIP	\$6,450	265	17.1	60" x 29 1/4" x 39 1/2"	115 / 8.2 / 1/4	2 / 4
72"	WTR72AY-FIP	\$7,385	305	21.5	72" x 29 1/4" x 39 1/2"	115 / 8.2 / 1/5	3 / 6

For total depth add 2" for bumper and 1" for handle. Height includes 6" legs or casters and 4" backslash. ADA compliant models feature 3" casters and reduce height to 36 1/2".

FLAT TOP WORKTOP REFRIGERATORS 29" BASE - SPECIFICATIONS

	MODELS	LIST PRICE	CRATED WEIGHT	CUBIC FEET	EXT. DIMENSIONS - W x D x H	VOLTS / AMPS / HP	DOORS/ SHELVES
24"	WTR24A-FLT	\$3,806	160	7.0	24" x 29 1/4" x 35 5/8"	115/5.0/1/6	1 / 2
27"	WTR27A-FLT	\$3,806	161	7.3	27" x 29 1/4" x 35 5/8"	115 / 4.0 / 1/6	1 / 2
36"	WTR36A-FLT	\$5,320	210	8.5	36" x 29 1/4" x 35 5/8"	115 / 3.3 / 1/5	2 / 2
48"	WTR48A-FLT	\$5,800	235	13.9	48" x 29 1/4" x 35 5/8"	115 / 3.3 / 1/5	2 / 4
60"	WTR60A-FLT	\$6,450	265	17.1	60" x 29 1/4" x 35 5/8"	115 / 8.2 / 1/4	2 / 4
72"	WTR72AY-FLT	\$7,385	305	21.5	72" x 29 1/4" x 35 5/8"	115 / 8.2 / 1/5	3 / 6

For total depth add 2" for bumper and 1" for handle. Height includes 6" legs or casters and 4" backslash. ADA compliant models feature 3" casters and reduce height to 36 1/2".

OPTIONAL

SUFFIX LEGEND

SUFFIX	OPTION
-09	Door Locks
-17	6" Legs
-23	3" Casters
-24	Left Hand Hinge Door(s)
-25	Glass Door(s) with LED lights

Specify model + optional suffix when placing order. See Accessories Section for pricing.

16" GAUGE TOP OPTION

27"	36"	48"	60"	72"
\$800	\$850	\$950	\$1,085	\$1,250

WORKTOP REFRIGERATORS & FREEZERS

Worktop Refrigerators & Freezers - 29" Base Only

TESTED & CERTIFIED TO AMBIENT CLASS OF 100°F

WORKTOP REFRIGERATORS 29" BASE WITH DRAWERS - SPECIFICATIONS

	MODELS	LIST PRICE	CRATED WEIGHT	CUBIC FEET	EXT. DIMENSIONS - W x D x H	VOLTS / AMPS / HP	DRAWERS/ DOORS	SHELVES
27"	WTRD27A-2	\$5,700	164	7.3	27" x 29 1/4" x 39 1/2"	115 / 4.0 / 1/6	2 / -	-
36"	WTRD36A-2	\$7,393	210	8.5	36" x 29 1/4" x 39 1/2"	115 / 3.3 / 1/5	2 / -	-
48"	WTRD48A-2	\$7,675	242	13.9	48" x 29 1/4" x 39 1/2"	115 / 3.3 / 1/5	2 / 1	2
	WTRD48A-4	\$9,500	242	13.9	48" x 29 1/4" x 39 1/2"	115 / 3.3 / 1/5	4 / -	-
60"	WTRD60A-2	\$8,300	271	17.1	60" x 29 1/4" x 39 1/2"	115 / 8.2 / 1/4	2 / 1	2
	WTRD60A-4	\$10,100	271	17.1	60" x 29 1/4" x 39 1/2"	115 / 8.2 / 1/4	4 / -	-
72"	WTRD72AY-2	\$10,400	330	21.5	72" x 29 1/4" x 39 1/2"	115 / 8.2 / 1/4	2 / 2	4
	WTRD72AY-4	\$11,209	330	21.5	72" x 29 1/4" x 39 1/2"	115 / 8.2 / 1/4	4 / 1	2
	WTRD72AY-6	\$13,194	330	21.5	72" x 29 1/4" x 39 1/2"	115 / 8.2 / 1/4	6 / -	-

For total depth add 2" for bumper and 1" for handle. Height includes 6" legs or casters and 4" backsplash. ♿ ADA compliant models feature 3" casters and reduce height to 36 1/2".

FOAMED-IN PLACE WORKTOP REFRIGERATORS 29" BASE WITH DRAWERS - SPECIFICATIONS

	MODELS	LIST PRICE	CRATED WEIGHT	CUBIC FEET	EXT. DIMENSIONS - W x D x H	VOLTS / AMPS / HP	DRAWERS/ DOORS	SHELVES
27"	WTRD27A-2-FIP	\$5,700	164	7.3	27" x 29 1/4" x 39 1/2"	115 / 4.0 / 1/6	2 / -	-
36"	WTRD36A-2-FIP	\$7,393	210	8.5	36" x 29 1/4" x 39 1/2"	115 / 3.3 / 1/5	2 / -	-
48"	WTRD48A-2-FIP	\$7,675	242	13.9	48" x 29 1/4" x 39 1/2"	115 / 3.3 / 1/5	2 / 1	2
	WTRD48A-4-FIP	\$9,500	242	13.9	48" x 29 1/4" x 39 1/2"	115 / 3.3 / 1/5	4 / -	-
60"	WTRD60A-2-FIP	\$8,300	271	17.1	60" x 29 1/4" x 39 1/2"	115 / 8.2 / 1/4	2 / 1	2
	WTRD60A-4-FIP	\$10,100	271	17.1	60" x 29 1/4" x 39 1/2"	115 / 8.2 / 1/4	4 / -	-
72"	WTRD72AY-2-FIP	\$10,400	330	21.5	72" x 29 1/4" x 39 1/2"	115 / 8.2 / 1/4	2 / 2	4
	WTRD72AY-4-FIP	\$11,209	330	21.5	72" x 29 1/4" x 39 1/2"	115 / 8.2 / 1/4	4 / 1	2
	WTRD72AY-6-FIP	\$13,194	330	21.5	72" x 29 1/4" x 39 1/2"	115 / 8.2 / 1/4	6 / -	-

For total depth add 2" for bumper and 1" for handle. Height includes 6" legs or casters and 4" backsplash. ♿ ADA compliant models feature 3" casters and reduce height to 36 1/2".

FLAT TOP WORKTOP REFRIGERATORS 29" BASE WITH DRAWERS - SPECIFICATIONS

	MODELS	LIST PRICE	CRATED WEIGHT	CUBIC FEET	EXT. DIMENSIONS - W x D x H	VOLTS / AMPS / HP	DRAWERS/ DOORS	SHELVES
27"	WTRD27A-2-FLT	\$5,700	164	7.3	27" x 29 1/4" x 35 5/8"	115 / 4.0 / 1/6	2 / -	-
36"	WTRD36A-2-FLT	\$7,393	210	8.5	36" x 29 1/4" x 35 5/8"	115 / 3.3 / 1/5	2 / -	-
48"	WTRD48A-2-FLT	\$7,675	242	13.9	48" x 29 1/4" x 35 5/8"	115 / 3.3 / 1/5	2 / 1	2
	WTRD48A-4-FLT	\$9,500	242	13.9	48" x 29 1/4" x 35 5/8"	115 / 3.3 / 1/5	4 / -	-
60"	WTRD60A-2-FLT	\$8,300	271	17.1	60" x 29 1/4" x 35 5/8"	115 / 8.2 / 1/4	2 / 1	2
	WTRD60A-4-FLT	\$10,100	271	17.1	60" x 29 1/4" x 35 5/8"	115 / 8.2 / 1/4	4 / -	-
72"	WTRD72AY-2-FLT	\$10,400	330	21.5	72" x 29 1/4" x 35 5/8"	115 / 8.2 / 1/4	2 / 2	4
	WTRD72AY-4-FLT	\$11,209	330	21.5	72" x 29 1/4" x 35 5/8"	115 / 8.2 / 1/4	4 / 1	2
	WTRD72AY-6-FLT	\$13,194	330	21.5	72" x 29 1/4" x 35 5/8"	115 / 8.2 / 1/4	6 / -	-

For total depth add 2" for bumper and 1" for handle. Height includes 6" legs or casters and 4" backsplash. ♿ ADA compliant models feature 3" casters and reduce height to 36 1/2".



GLASS DOOR WORKTOP FREEZERS 29" BASE - SPECIFICATIONS

	MODELS	LIST PRICE	CRATED WEIGHT	CUBIC FEET	EXT. DIMENSIONS – W x D x H	VOLTS / AMPS / HP	DOORS/ SHELVES
24"	WTF24A-25	\$6,550	181	7.3	24" x 29 1/4" x 39 1/2"	115 / 6.0 / 1/4	1 / 2
	WTF24A-25-FIP	\$6,550	181	7.3	24" x 29 1/4" x 39 1/2"	115 / 6.0 / 1/4	1 / 2
	WTF24A-25-FLT	\$6,550	181	7.3	24" x 29 1/4" x 35 5/8"	115 / 6.0 / 1/4	1 / 2
27"	WTF27A-25	\$5,259	166	7.3	27" x 29 1/4" x 39 1/2"	115 / 6.0 / 1/4	1 / 2
	WTF27A-25-FIP	\$5,259	166	7.3	27" x 29 1/4" x 39 1/2"	115 / 6.0 / 1/4	1 / 2
	WTF27A-25-FLT	\$5,259	166	7.3	27" x 29 1/4" x 35 5/8"	115 / 6.0 / 1/4	1 / 2

REMOVEABLE BACKSPLASH WORKTOP FREEZERS - 29" BASE - SPECIFICATIONS

	MODELS	LIST PRICE	CRATED WEIGHT	CUBIC FEET	EXT. DIMENSIONS – W x D x H	VOLTS / AMPS / HP	DOORS/ SHELVES
24"	WTF24A	\$4,550	166	7.0	24" x 29 1/4" x 39 1/2"	115 / 6.0 / 1/4	1 / 2
	WTF24A-FB	\$5,950	201	5.0	24" X 27" X 37 1/2"	115 / 5.5 / 1/4	1 / 2
27"	WTF27AY	\$4,550	166	7.3	27" x 29 1/4" x 39 1/2"	115 / 6.0 / 1/4	1 / 2
36"	WTF36A	\$6,153	218	8.5	36" x 29 1/4" x 39 1/2"	115 / 6.0 / 1/3	2 / 2
48"	WTF48AY	\$6,700	246	13.9	48" x 29 1/4" x 39 1/2"	115 / 7.0 / 1/3	2 / 4
60"	WTF60A	\$8,300	265	17.1	60" X 29 1/4" X 39 1/2"	115 / 7.0 / 1/3	2 / 4

For total depth add 2" for bumper and 1" for handle. Height includes 6" legs or casters and 4" backsplash. ADA compliant models feature 3" casters and reduce height to 36 1/2".

FOAMED-IN PLACE BACKSPLASH FREEZERS - 29" BASE - SPECIFICATIONS

	MODELS	LIST PRICE	CRATED WEIGHT	CUBIC FEET	EXT. DIMENSIONS – W x D x H	VOLTS / AMPS / HP	DOORS/ SHELVES
24"	WTF24A-FIP	\$4,550	166	7.0	24" x 29 1/4" x 39 1/2"	115 / 6.0 / 1/4	1 / 2
27"	WTF27AY-FIP	\$4,550	166	7.3	27" x 29 1/4" x 39 1/2"	115 / 6.0 / 1/4	1 / 2
36"	WTF36A-FIP	\$6,153	218	8.5	36" x 29 1/4" x 39 1/2"	115 / 6.0 / 1/3	2 / 2
48"	WTF48AY-FIP	\$6,700	246	13.9	48" x 29 1/4" x 39 1/2"	115 / 7.0 / 1/3	2 / 4
60"	WTF60A-FIP	\$8,300	265	17.1	60" X 29 1/4" X 39 1/2"	115 / 7.0 / 1/3	2 / 4

For total depth add 2" for bumper and 1" for handle. Height includes 6" legs or casters and 4" backsplash. ADA compliant models feature 3" casters and reduce height to 36 1/2".

FLAT TOP WORKTOP FREEZERS - 29" BASE - SPECIFICATIONS

	MODELS	LIST PRICE	CRATED WEIGHT	CUBIC FEET	EXT. DIMENSIONS – W x D x H	VOLTS / AMPS / HP	DOORS/ SHELVES
24"	WTF24A-FLT	\$4,550	166	7.0	24" x 24 1/4" x 35 5/8"	115 / 6.0 / 1/4	1 / 2
27"	WTF27AY-FLT	\$4,550	166	7.3	27" x 29 1/4" x 35 5/8"	115 / 6.0 / 1/4	1 / 2
36"	WTF36A-FLT	\$6,153	218	8.5	36" x 29 1/4" x 35 5/8"	115 / 6.0 / 1/3	2 / 2
48"	WTF48AY-FLT	\$6,700	246	13.9	48" x 29 1/4" x 35 5/8"	115 / 7.0 / 1/3	2 / 4
60"	WTF60A-FLT	\$8,300	265	17.1	60" X 29 1/4" X 35 5/8"	115 / 7.0 / 1/3	2 / 4

For total depth add 2" for bumper and 1" for handle. Height includes 6" legs or casters and 4" backsplash. ADA compliant models feature 3" casters and reduce height to 36 1/2".

WORKTOP REFRIGERATORS & FREEZERS

- ▶ Refrigerators, Freezers & Dual Temperature Models - 29" Base
- ▶ Drawer Models, Foamed-In Place, Flat Top

TESTED & CERTIFIED TO AMBIENT CLASS OF 100°F

WORKTOP FREEZERS 29" BASE WITH DRAWERS - SPECIFICATIONS

	MODELS	LIST PRICE	CRATED WEIGHT	CUBIC FEET	EXT. DIMENSIONS - W x D x H	VOLTS / AMPS / HP	DRAWERS/ DOORS	SHELVES
27"	WTFD27A-2	\$6,400	164	7.3	27" x 29 1/4" x 39 1/2"	115 / 4.0 / 1/6	2 / -	-
36"	WTFD36A-2	\$8,100	210	8.5	36" x 29 1/4" x 39 1/2"	115 / 3.3 / 1/5	2 / -	-
48"	WTFD48A-2	\$8,300	242	13.9	48" x 29 1/4" x 39 1/2"	115 / 3.3 / 1/5	2 / 1	2
	WTFD48A-4	\$8,600	242	13.9	48" x 29 1/4" x 39 1/2"	115 / 3.3 / 1/5	4 / -	-
60"	WTFD60A-2	\$10,000	271	17.1	60" x 29 1/4" x 39 1/2"	115 / 8.2 / 1/4	2 / 1	2
	WTFD60A-4	\$10,200	271	17.1	60" x 29 1/4" x 39 1/2"	115 / 8.2 / 1/4	4 / -	-

For total depth add 2" for bumper and 1" for handle. Height includes 6" legs or casters and 4" backslash.  ADA compliant models feature 3" casters and reduce height to 36 1/2".

FOAMED-IN PLACE WORKTOP FREEZERS 29" BASE WITH DRAWERS - SPECIFICATIONS

	MODELS	LIST PRICE	CRATED WEIGHT	CUBIC FEET	EXT. DIMENSIONS - W x D x H	VOLTS / AMPS / HP	DRAWERS/ DOORS	SHELVES
27"	WTFD27A-2-FIP	\$6,400	164	7.3	27" x 29 1/4" x 39 1/2"	115 / 4.0 / 1/6	2 / -	-
36"	WTFD36A-2-FIP	\$8,100	210	8.5	36" x 29 1/4" x 39 1/2"	115 / 3.3 / 1/5	2 / -	-
48"	WTFD48A-2-FIP	\$8,300	242	13.9	48" x 29 1/4" x 39 1/2"	115 / 3.3 / 1/5	2 / 1	2
	WTFD48A-4-FIP	\$8,600	242	13.9	48" x 29 1/4" x 39 1/2"	115 / 3.3 / 1/5	4 / -	-
60"	WTFD60A-2-FIP	\$10,000	271	17.1	60" x 29 1/4" x 39 1/2"	115 / 8.2 / 1/4	2 / 1	2
	WTFD60A-4-FIP	\$10,200	271	17.1	60" x 29 1/4" x 39 1/2"	115 / 8.2 / 1/4	4 / -	-

For total depth add 2" for bumper and 1" for handle. Height includes 6" legs or casters and 4" backslash.  ADA compliant models feature 3" casters and reduce height to 36 1/2".

FLAT TOP WORKTOP FREEZERS 29" BASE WITH DRAWERS - SPECIFICATIONS

	MODELS	LIST PRICE	CRATED WEIGHT	CUBIC FEET	EXT. DIMENSIONS - W x D x H	VOLTS / AMPS / HP	DRAWERS/ DOORS	SHELVES
27"	WTFD27A-2-FLT	\$6,400	164	7.3	27" x 29 1/4" x 35 5/8"	115 / 4.0 / 1/6	2 / -	-
36"	WTFD36A-2-FLT	\$8,100	210	8.5	36" x 29 1/4" x 35 5/8"	115 / 3.3 / 1/5	2 / -	-
48"	WTFD48A-2-FLT	\$8,300	242	13.9	48" x 29 1/4" x 35 5/8"	115 / 3.3 / 1/5	2 / 1	2
	WTFD48A-4-FLT	\$8,600	242	13.9	48" x 29 1/4" x 35 5/8"	115 / 3.3 / 1/5	4 / -	-
60"	WTFD60A-2-FLT	\$10,000	271	17.1	60" x 29 1/4" x 35 5/8"	115 / 8.2 / 1/4	2 / 1	2
	WTFD60A-4-FLT	\$10,200	271	17.1	60" x 29 1/4" x 35 5/8"	115 / 8.2 / 1/4	4 / -	-

For total depth add 2" for bumper and 1" for handle. Height includes 6" legs or casters and 4" backslash.  ADA compliant models feature 3" casters and reduce height to 36 1/2".

AVAILABLE ACCESSORIES:

- ▶ Cutting Board Top Options
- ▶ Shelf Dividers
- ▶ Overshelf Kits
- ▶ Composite Cutting Boards
- ▶ Foot Pedal Door Opener



YOUR COMPLETE REFRIGERATION SOURCE

DUAL-TEMP WORKTOP REFRIGERATORS/FREEZERS - SPECIFICATIONS

	MODELS	LIST PRICE	CRATED WEIGHT	CUBIC FEET	EXT. DIMENSIONS - W x D x H	VOLTS / AMPS / HP	DOORS/SHELVES
48"	WTRF48A	\$8,600	224	12.6	48" x 29 1/4" x 39 1/2"	115 / 4.0 / 1/6 - REFER 115 / 6.0 / 1/4 - FREEZER	2 / 4
	WTRF48A-FIP	\$8,600	224	12.6	48" x 29 1/4" x 39 1/2"	115 / 4.0 / 1/6 - REFER 115 / 6.0 / 1/4 - FREEZER	2 / 4
	WTRF48A-FLT	\$8,600	224	12.6	48" x 29 1/4" x 35 1/2"	115 / 4.0 / 1/6 - REFER 115 / 6.0 / 1/4 - FREEZER	2 / 4
50"	WTRF50A	\$8,755	245	14.6	50" x 29 1/4" x 39 1/2"	115 / 4.0 / 1/6 - REFER 115 / 6.0 / 1/4 - FREEZER	2 / 4
	WTRF50A-FIP	\$8,755	245	14.6	50" x 29 1/4" x 39 1/2"	115 / 4.0 / 1/6 - REFER 115 / 6.0 / 1/4 - FREEZER	2 / 4
	WTRF50A-FLT	\$8,755	245	14.6	50" x 29 1/4" x 35 1/2"	115 / 4.0 / 1/6 - REFER 115 / 6.0 / 1/4 - FREEZER	2 / 4
52"	WTRF52A	\$9,017	245	15.5	52" x 29 1/4" x 39 1/2"	115 / 4.0 / 1/6 - REFER 115 / 6.0 / 1/4 - FREEZER	2 / 4
	WTRF52A-FIP	\$9,017	245	15.5	52" x 29 1/4" x 39 1/2"	115 / 4.0 / 1/6 - REFER 115 / 6.0 / 1/4 - FREEZER	2 / 4
	WTRF52A-FLT	\$9,017	245	15.5	52" x 29 1/4" x 35 1/2"	115 / 4.0 / 1/6 - REFER 115 / 6.0 / 1/4 - FREEZER	2 / 4

For total depth add 2" for bumper and 1" for handle. Height includes 6" legs or casters and 4" backsplash. ADA compliant models feature 3" casters and reduce height to 36 1/2".

WORKTOP REFRIGERATORS SHALLOW DEPTH - SPECIFICATIONS

	MODELS	LIST PRICE	CRATED WEIGHT	CUBIC FEET	EXT. DIMENSIONS - W x D x H	VOLTS / AMPS / HP	DRAWERS/DOORS
20"	WTR20Y	\$4,153	116	2.7	20" X 22 17/32" X 31 9/32"	115 / 3.0 / 1/6	1 / 2
	WTR20Y-FIP	\$4,153	116	2.7	20" X 22 17/32" X 31 9/32"	115 / 3.0 / 1/6	1 / 2
	WTR20Y-FLT	\$4,153	116	2.7	20" X 22 17/32" X 31 9/32"	115 / 3.0 / 1/6	1 / 2
27"	WTR27	\$3,806	160	6.2	27" x 25 3/4" X 39 1/2"	115 / 4.0 / 1/6	1 / 2
	WTR27-FIP	\$3,806	160	6.2	27" x 25 3/4" X 39 1/2"	115 / 4.0 / 1/6	1 / 2
	WTR27-FLT	\$3,806	160	6.2	27" x 25 3/4" X 39 1/2"	115 / 4.0 / 1/6	1 / 2
34"	WTR34Y	\$5,788	171	5.5	34" X 22 23/32" X 31 9/32"	115 / 3.0 / 1/6	2 / 4
	WTR34Y-FIP	\$5,788	171	5.5	34" X 22 23/32" X 31 9/32"	115 / 3.0 / 1/6	2 / 4
	WTR34Y-FLT	\$5,788	171	5.5	34" X 22 23/32" X 31 9/32"	115 / 3.0 / 1/6	2 / 4

WORKTOP FREEZERS SHALLOW DEPTH - SPECIFICATIONS

	MODELS	LIST PRICE	CRATED WEIGHT	CUBIC FEET	EXT. DIMENSIONS - W x D x H	VOLTS / AMPS / HP	DRAWERS/DOORS
20"	WTF20Y	\$4,333	137	2.7	20" X 22 17/32" X 31 9/32"	115 / 5.3 / 1/4	1 / 2
	WTF20Y-FIP	\$4,333	137	2.7	20" X 22 17/32" X 31 9/32"	115 / 5.3 / 1/4	1 / 2
	WTF20Y-FLT	\$4,333	137	2.7	20" X 22 17/32" X 31 9/32"	115 / 5.3 / 1/4	1 / 2
24"	WTF24A	\$4,550	165	7.0	24" x 29 1/4" x 39 1/2"	115 / 6.0 / 1/4	1 / 2
27"	WTF27Y	\$4,550	162	6.2	27" X 25 3/4" X 39 1/2"	115 / 6.0 / 1/4	1 / 2
	WTF27Y-FIP	\$4,550	162	6.2	27" X 25 3/4" X 39 1/2"	115 / 6.0 / 1/4	1 / 2
	WTF27Y-FLT	\$4,550	162	6.2	27" X 25 3/4" X 35 1/2"	115 / 6.0 / 1/4	1 / 2

OPTIONAL SUFFIX LEGEND

SUFFIX	OPTION
-02	S/S Interior
-09	Door Locks
-16	3" Casters (UCR34Y Only)
-23	3" Casters
-24	Left Hand Hinge Door(s) (Excludes UCR34Y)
-25	Glass Door(s) with LED Light
-29	Door Thermometer
-46	Left Hinge Door(s) & 3" Casters Packed

Specify model + optional suffix when placing order. See Accessories Section for pricing.

WORKTOP REFRIGERATORS & FREEZERS

Worktop Refrigerators & Freezers - 32" Base

STANDARD

16 Gauge
Stainless
Steel Top

TESTED & CERTIFIED TO AMBIENT CLASS OF 100°F

Worktop Refrigerators & Freezers 32" Base FEATURES:

Cabinet Finish

Stainless steel exterior front, top and sides. Aluminum interior to prevent corrosion.

100% Front Breathing

Heavy Duty Construction

2" CFC and HCFC-free foamed-in-place polyurethane insulation.

Durable Worktop

2 1/2" thick 16 gauge stainless steel worktop for added durability.

Built-In Backsplash

4" High built-in backsplash.

120° Stay-Open Door Feature

2 Epoxy Coated Shelves Per Door Section Standard

(Models with doors) Includes 1 large shelf, 1 small shelf.

Field Reversible Doors

Door and Drawer Units Available

Drawer Pan Supports

Heavy duty pan supports provided hold pans in place. Drawers accommodate up to 6" deep pans. Food service pans are not included.

Snap-In Door and Drawer Gaskets

Easy to remove for cleaning or replacement without service agency.

Cartidge style Hinges

6" Heavy Duty Casters Standard (3" Casters or 6" Legs Optional)

3" caster (ADA Compliant) or 6" leg option available at no charge when specified on order (in lieu of 6" casters).

Refrigeration System

Operates at 36°–38°F for optimum food preservation.

Environmentally Friendly Refrigerant

Refrigerators utilize R134a & freezers utilize R404a refrigerant, which are CFC and HCFC-free for compliance with environmental safety standards.

Agency Certifications



Products that have earned the ENERGY STAR® are designed to protect the environment through superior energy efficiency. For a complete list of qualified models, visit www.energystar.gov/cfs. Click on Commercial Refrigerators & Freezers on the right-hand side of the page.

WTR67A,
WTF67A



WTRD67A-2



WTRD67A-4



OPTIONAL SUFFIX LEGEND

SUFFIX	OPTION
-09	Door Locks
-17	6" Legs
-23	3" Casters
-24	Left Hand Hinge Door(s)

Specify model + optional suffix when placing order. See Accessories Section for pricing.

WORKTOP FREEZER 32" BASE - SPECIFICATIONS

	MODELS	LIST PRICE	CRATED WEIGHT	CUBIC FEET	EXT. DIMENSIONS - W x D x H	VOLTS / AMPS / HP	DOORS / SHELVES
67"	WTF67A	\$10,990	431	27	67" x 32" x 39 1/2"	115 / 8.6 / 3/4	2 / 4

For total depth add 2" for bumper and 1" for handle. Height includes 6" legs casters and 4" backsplash. ADA compliant models feature 3" casters and reduces height to 36 1/2".

AVAILABLE ACCESSORIES:

- ▶ Cutting Board Top Options
- ▶ Shelf Dividers
- ▶ Overshelf Kits
- ▶ Composite Cutting Boards
- ▶ Foot Pedal Door Opener



YOUR COMPLETE REFRIGERATION SOURCE

WORKTOP REFRIGERATORS 32" BASE - SPECIFICATIONS

	MODELS	LIST PRICE	CRATED WEIGHT	CUBIC FEET	EXT. DIMENSIONS - W x D x H	VOLTS / AMPS / HP	DOORS / SHELVES
41"	WTR41	\$5,213	295	8.3	41" x 32" x 39 1/2"	115 / 5.5 / 1/4	1 / 2
46"	WTR46A	\$6,300	330	16.7	46" x 32" x 39 1/2"	115 / 6.3 / 1/4	1 / 2
67"	WTR67A	\$7,850	420	27	67" x 32" x 39 1/2"	115 / 6.3 / 1/4	2 / 4
93"	WTR93A	\$10,430	546	39.8	93" x 32" x 39 1/2"	115 / 8.6 / 1/3	3 / 6
119"	WTR119A	\$14,340	675	52.5	119" x 32" x 39 1/2"	115 / 8.6 / 1/3	4 / 8

For total depth add 2" for bumper and 1" for handle. Height includes 6" legs or casters and 4" backsplash. ♿ ADA compliant models feature 3" casters and reduces height to 36 1/2".

WORKTOP REFRIGERATORS 32" BASE WITH DRAWERS - SPECIFICATIONS

	MODELS	LIST PRICE	CRATED WEIGHT	CUBIC FEET	EXT. DIMENSIONS - W x D x H	VOLTS / AMPS / HP	DRAWERS / DOORS	SHELVES
46"	WTRD46A-2	\$8,540	225	16.7	46" x 32" x 39 1/2"	115 / 6.3 / 1/4	2 / -	-
67"	WTRD67A-2	\$9,990	410	27	67" x 32" x 39 1/2"	115 / 6.3 / 1/4	2 / 1	2
	WTRD67A-4	\$12,300	410	27	67" x 32" x 39 1/2"	115 / 6.3 / 1/4	4 / -	-
93"	WTRD93A-2	\$12,625	486	39.8	93" x 32" x 39 1/2"	115 / 8.6 / 1/3	2 / 2	4
	WTRD93A-4	\$14,825	486	39.8	93" x 32" x 39 1/2"	115 / 8.6 / 1/3	4 / 1	2
	WTRD93A-6	\$17,100	486	39.8	93" x 32" x 39 1/2"	115 / 8.6 / 1/3	6 / -	-
119"	WTRD119A-2	\$15,727	604	52.5	119" x 32" x 39 1/2"	115 / 8.6 / 1/3	2 / 3	6
	WTRD119A-4	\$17,902	604	52.5	119" x 32" x 39 1/2"	115 / 8.6 / 1/3	4 / 2	4
	WTRD119A-6	\$20,078	604	52.5	119" x 32" x 39 1/2"	115 / 8.6 / 1/3	6 / 1	2
	WTRD119A-8	\$21,696	604	52.5	119" x 32" x 39 1/2"	115 / 8.6 / 1/3	8 / -	-

For total depth add 2" for bumper and 1" for handle. Height includes 6" legs or casters and 4" backsplash. ♿ ADA compliant models feature 3" casters and reduces height to 36 1/2".

DRAWER SUPPORT CAPACITY - PER DRAWER

MODELS	# OF PANS SUPPORTS (SUPPLIED)	POSSIBLE PAN CONFIGURATION		POSSIBLE PAN CONFIGURATION	
WTRD46 - WTRD119	2	1 full	3 1/6 size	2 1/2 size	3 1/6 size
		3 1/3 size	3 1/6 size	9 1/6 size	